



PROPERTY ANALYSIS LOCATION REPORT (PALR)

What is a Property Analysis Location Report?

It is a location of structures or improvements on the property and a cursory check for encroachments onto or from the subject property based upon existing but not confirmed evidence found at the time of the inspection. No property corners will be set. The property dimensions shown are based upon unverified record or deed information. The PALR does not constitute a boundary survey and is subject to any inaccuracies that a subsequent boundary survey may disclose.

What is included in your PALR?

We will create a professional color report for your property that will include the following items:
PALR Plan showing structures, setbacks, walls, fences, and any possible encroachments.
Any easements or right-of-ways on the property.
Copy of the latest Deed, Record Plan, & Assessor Map.
Photos of the site.
Recommended survey services.
A picture is worth a 1,000 words!
Prices starting at \$495.

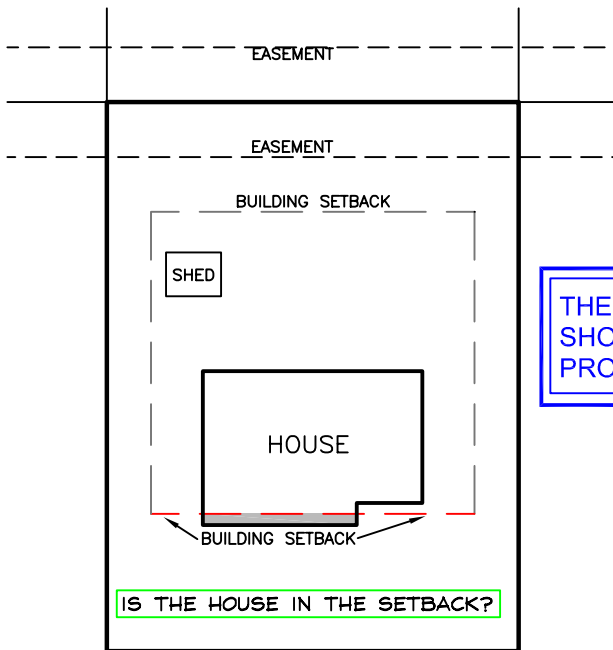

SMITH STREET

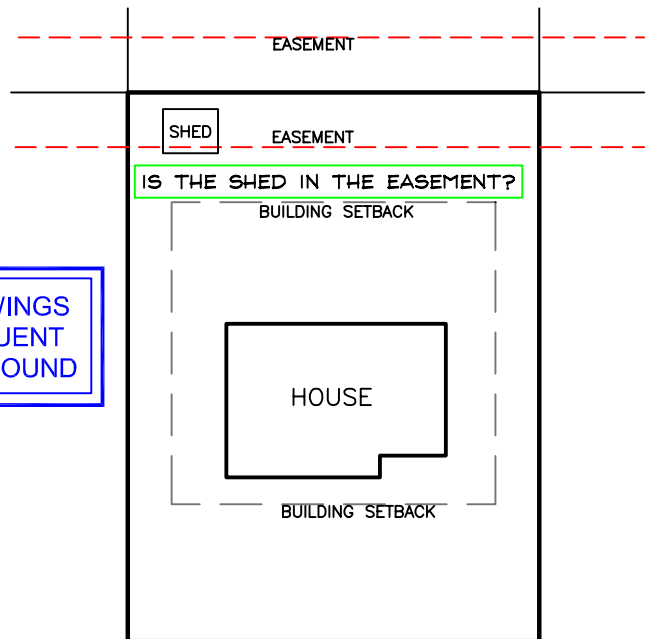

SMITH STREET

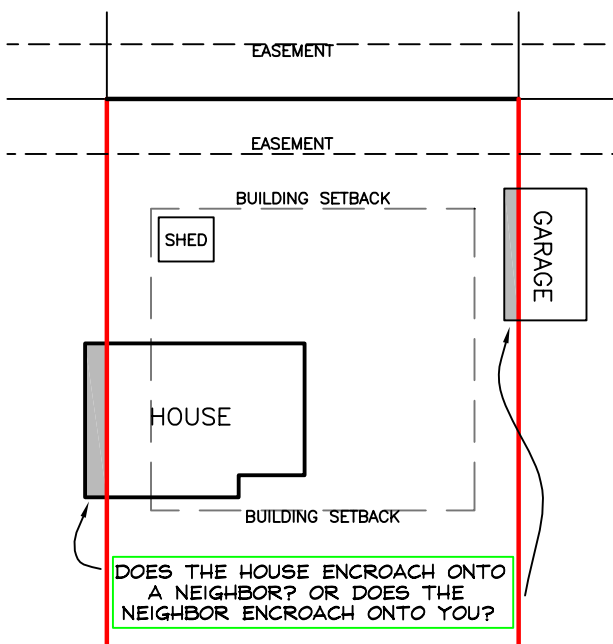

SMITH STREET

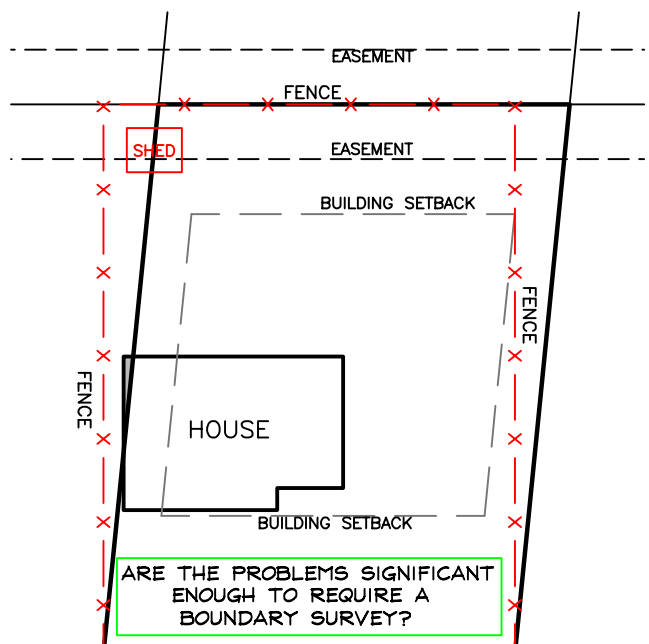

SMITH STREET